

**ILY-SS Loadcell**

**ILY-SS**

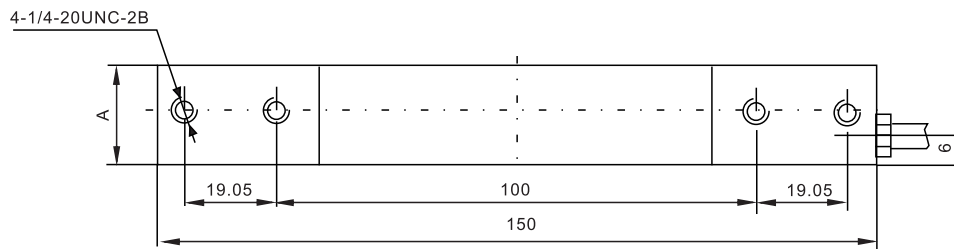

Rated Load (kg)	A
8,10,15,20,30,	20
50,100	25.2

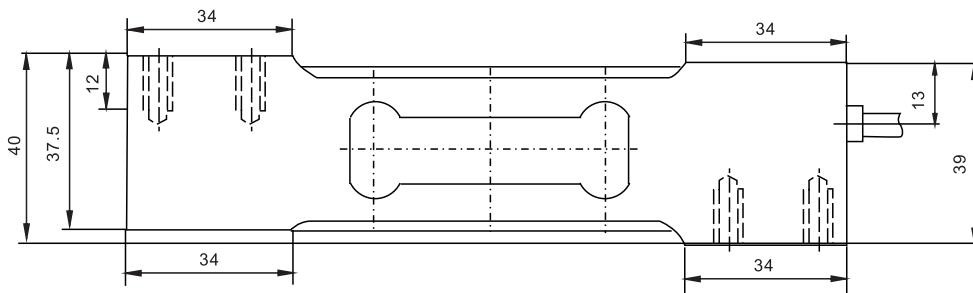

Blending scale, packing scale, dynamic testing system, platform scale

**TECHNICAL PARAMETER** OAP version 4Wires:Exc+(Blue);Exc-(Black);Sig+(White);Sig-(Red)

Rated capacities(Emax)	8,10,15,20,30,50,100kg	Temperature range, compensated	-10°C~+40°C
Sensitivity	2.0±0.2mV/V	Temperature range, operating	-30~+70°C
Total error	±0.03%F.S	Maximum safe overload	150%F.S
Creep error (30min)	±0.03%F.S	Ultimate overload	200%F.S
Zero balance	±1%F.S	Excitation, recommended	10~12V DC
TC ZERO	±0.02%F.S/10°C	Excitation, maximum	15V DC
TC SPAN	±0.02%F.S/10°C	Protection class	IP65
Input resistance	400±20 Ω	Construction	Stainless Steel
Output resistance	352±3 Ω	Cable	Length: 3m
Insulation resistance	≥5000M Ω		Diameter: φ 5mm